

Disney's Wilderness Lodge & Villas

This Disney Deluxe Resort and Disney Deluxe Villa Resort celebrates the grandeur of the glorious national parks of America's great Northwest. Your clients will bask in the harmony of natural elements while they sample the beauty and majesty of the great outdoors.

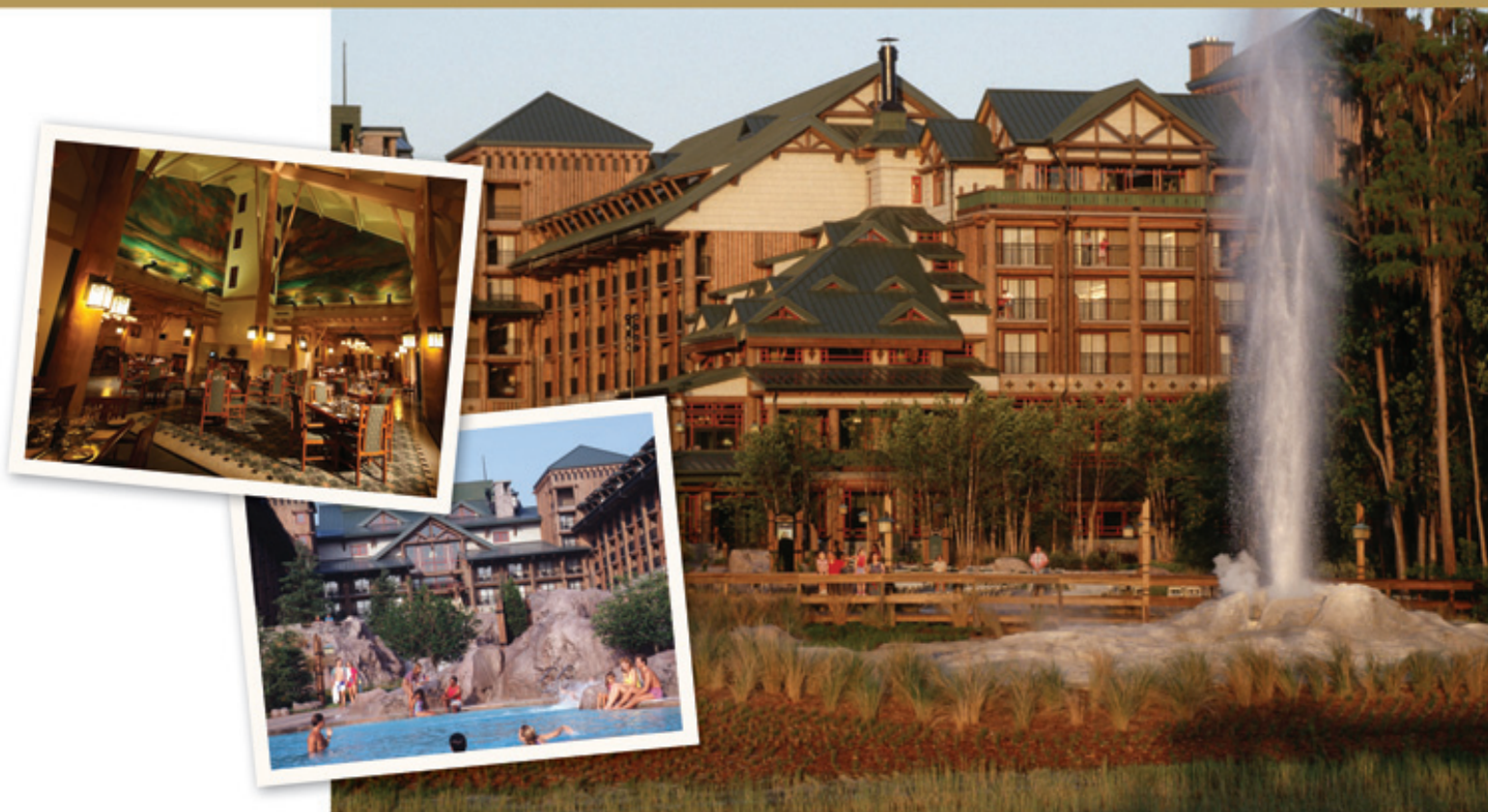

- | | |
|--|--------------------------------|
| 1 Registration/Lobby/Concierge | 13 Wading Pool |
| 2 Whispering Canyon Cafe | 14 Silver Creek Spas |
| 3 Wilderness Lodge Mercantile | 15 Ferry/Boat Transportation |
| 4 Buttons & Bells Arcade | 16 Fire Rock Geyser |
| 5 Cub's Den Children's Activity Center | 17 Trout Pass Pool Bar |
| 6 Territory Lounge | 18 Teton Boat & Bike Rental |
| 7 Artist Point | 19 Nature Trail |
| 8 Roaring Fork | 20 Hidden Springs Spa |
| 9 Guest Laundry Facility | 21 Hidden Springs Pool |
| 10 Silver Creek Falls | 22 Bike & Jogging Path |
| 11 Silver Creek | 23 Sturdy Branches Health Club |
| 12 Silver Creek Springs (pool) | Bus Transportation |

Room Accommodations

- 727 Rooms, 181 Villas.
- Rooms accommodate up to four Guests, plus one child under age 3 in a crib.
- All rooms have two queen-size beds, or one queen-size bed and bunk beds, or one king-size bed and private balcony or patio.
- Guests choosing **Club Level** accommodations at the *Old Faithful Club* receive personalized concierge service, lounge with continental breakfast, midday snacks, afternoon tea and evening wine, hors d'oeuvres, cordials and desserts.

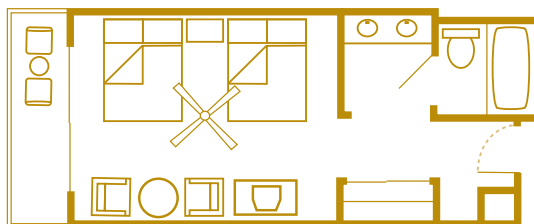

Typical Standard Room, Woods & Courtyard View, 340 Sq. Ft.



The Villas at Disney's Wilderness Lodge

Villa Accommodations

Two-Bedroom Villas accommodate up to eight Guests, plus one child under age 3 in a crib, and offer a fully equipped kitchen, master bedroom, second bedroom, DVD player and private porch or balcony.

One-Bedroom Villas accommodate up to five Guests, plus one child under age 3 in a crib, and offer a fully equipped kitchen, king-size bed in master bedroom and queen-size sleeper sofa in living room and private porch or balcony.

Deluxe Studios accommodate up to four Guests, plus one child under age 3 in a crib, and have a kitchenette, one queen-size bed, double-size sleeper sofa and private porch or balcony.



Dining

Signature Dining

- *Artist Point* – Dinner serving American cuisine with Pacific Northwest flavors. The ambience is inspired by the rustic yet elegant dining rooms in cherished national park lodges.

Table-Service Dining

- *Whispering Canyon Cafe* – Family-style, all-you-care-to-enjoy breakfast and BBQ lunch and dinner.

Quick-Service Dining

- *Roaring Fork* – Breakfast, lunch, dinner and snacks.

Other Dining Options

- Lounge serving appetizers, poolside bar, room service.

Recreation

- Two swimming pools, whirlpools, children's pool, themed water slide, health club, beach for sunbathing, fishing, marina watercraft rental, arcade, and recreation activities including Disney movies.

Just for Kids

- *Cub's Den* – Young cubs can enjoy a supervised evening filled with activities, video games and Disney movies from 4:30 p.m. to midnight (additional fee applies).

Transportation

- Water launch service to *Magic Kingdom*® Park and select *Disney Resort* hotels.
- Bus service to other *Walt Disney World*® Resort locations.

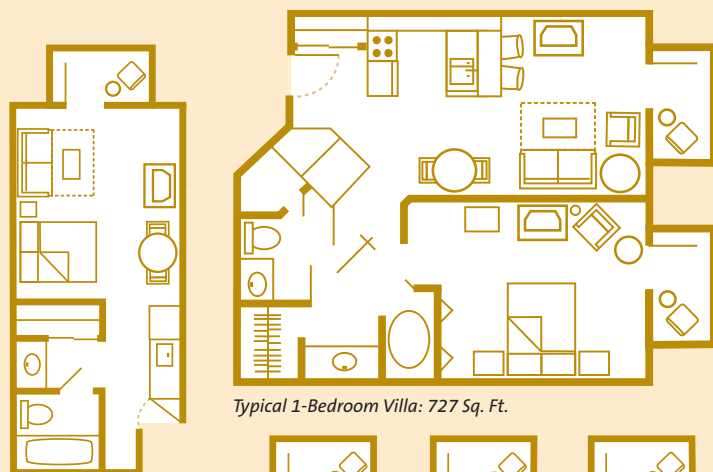

Typical 1-Bedroom Villa: 727 Sq. Ft.

Typical Deluxe Studio: 356 Sq. Ft.

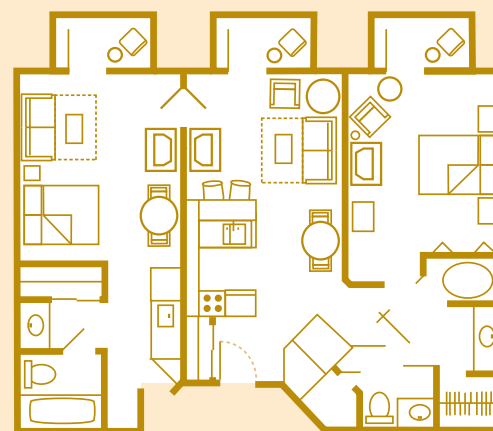

Typical 2-Bedroom Villa: 1,080 Sq. Ft.